



SBP-300BW

Wall Mount Base



Key Features

- Weight : 490g
- Material : Aluminum
- Operation temp. : -50°C~60°C
- Operation hum. : 0~100%

SBP-300BW

Wall Mount Base

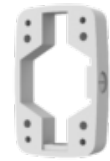

Specifications

Mechanical	
Color	White
Material	Aluminum
RAL code	RAL9003
Product dimensions / weight	120.0x190.9x35.0mm(4.72x7.52x1.38"), 700g
Conduit hole	19.1mm(3/4") (M25)
Supported products	SBP-300WMW, SBP-300WMW1 ※ For further compatible models, please visit our website or use Toolbox

SBP-300BW

Wall Mount Base

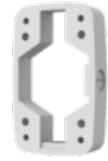

CAD

Unit:mm [inch]

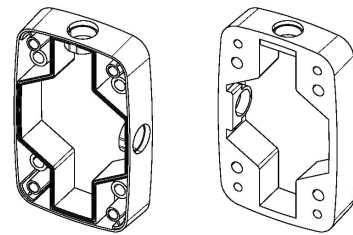
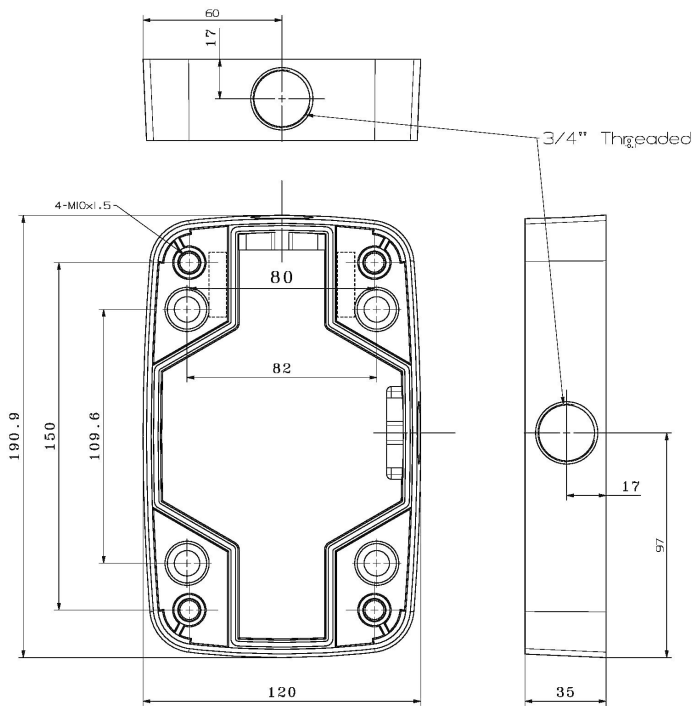

SBP-300B
unit : mm